

# SB8

## Bolt-style tensioner standard

SB8 bolt-style tensioners are most often used for applications with tapped holes. The diameter of the bolt-style tensioner head is smaller than a nut-style tensioner, so bolt-style tensioners can fit tighter spaces. They feature an external installation/removal hex.

Components:  
1 Bolt body  
2 Jackbolts  
3 Hardened washer

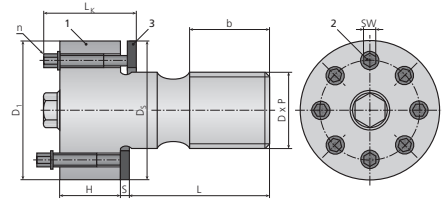

Metric	Size			Bolt body		Jackbolt		Hardened washer		Height	Preload*		Torque*		Preload capacity*	
	Part number	Thread D [mm]	Available pitch P <sub>1</sub> P <sub>2</sub> P <sub>3</sub> [mm]			D <sub>1</sub> [mm]	H [mm]	n	SW [mm]	D <sub>s</sub> [mm]	S [mm]	tot L <sub>k</sub> [mm]	nom F [kN]	nom M [Nm]	nom M [Nm]	max [kN]
SB8-M16x...x.../W	M16	2	1.5	1	31	18	4	5	30	3	32	73	14	94		
SB8-M20x...x.../W	M20	2.5	1.5	1	35	18	6	5	35	4	33	109	14	140		
SB8-M24x...x.../W	M24	3	2	1.5	41	18	8	5	41	4	33	146	14	187		
SB8-M27x...x.../W	M27	3	2	1.5	45	23	6	6	45	5	45	190	32	250		
SB8-M30x...x.../W	M30	3.5	2	1.5	50	23	6	6	50	5	45	214	36	286		
SB8-M33x...x.../W	M33	3.5	2	1.5	57	28	6	8	57	5	52	285	60	380		
SB8-M36x...x.../W	M36	4	3	1.5	60	28	6	8	60	5	52	333	70	443		
SB8-M39x...x.../W	M39	4	3	1.5	63	28	8	8	63	5	52	406	64	540		
SB8-M42x...x.../W	M42	4.5	3	1.5	66	28	8	8	66	5	52	457	72	610		
SB8-M45x...x.../W	M45	4.5	3	1.5	75	37	8	10	75	6	64	535	100	720		
SB8-M48x...x.../W	M48	5	3	1.5	78	37	8	10	78	6	64	605	113	800		
SB8-M52x...x.../W	M52	5	3	2	82	37	10	10	82	6	64	735	110	970		
SB8-M56x...x.../W	M56	5.5	4	2	86	37	10	10	86	6	64	835	125	1120		
SB8-M60x...x.../W	M60	5.5	4	2	90	37	12	10	90	6	64	985	123	1310		
SB8-M64x...x.../W	M64	6	4	2	103	46	8	14	103	8	83	950	235	1270		
SB8-M68x...x.../W	M68	6	4	2	107	46	8	14	107	8	83	1090	270	1450		
SB8-M72x...x.../W	M72	6	4	2	111	46	10	14	111	8	83	1230	245	1640		
SB8-M76x...x.../W	M76	6	4	2	116	46	12	14	116	8	83	1390	230	1870		
SB8-M80x...x.../W	M80	6	4	2	120	56	12	14	120	8	92	1570	260	2080		
SB8-M90x...x.../W	M90	6	4	2	130	56	16	14	130	8	92	2010	250	2700		
SB8-M100x...x.../W	M100	6	4	2	148	60	12	17	148	10	99	2540	520	3370		
SB8-M110x...x.../W	M110	6	4	2	158	60	14	17	158	10	99	2850	500	3750		
SB8-M120x...x.../W	M120	6	4	2	170	64	16	17	170	10	105	3380	520	4500		
SB8-M125x...x.../W	M125	6	4	2	175	64	16	17	175	10	105	3650	560	4880		
SB8-M130x...x.../W	M130	6	4	2	180	76	18	17	180	10	118	3950	540	5270		
SB8-M140x...x.../W	M140	6	4	2	190	76	20	17	190	10	118	4550	560	6100		
SB8-M150x...x.../W	M150	6	4	2	200	76	20	17	200	10	118	4880	600	6500		
SB8-M160x...x.../W	M160	6	4	-	210	76	20	17	210	10	118	5280	650	7000		

\* All preload and torque values are provided for general reference. Applied preload plus additional bolt load from service should not exceed the maximum bolt or stud capacity.

Contact your local Nord-Lock sales office for assistance in determining proper preload and torque settings for your application.

- Other sizes, thread pitches or thread per inch (TPI) may be available.

- Dimensions listed are representative.