

H650

Nut-style tensioner

Medium temperature

H650 tensioners are used for medium-temperature applications. Preload and torque values are based on a bolt stress of 310 MPa (45,000 psi), the value most commonly used by pressure-vessel designers. Depending on operating temperature, jackbolt torque and preload may be increased.

Components:
1 Nut body
2 Jackbolts
3 Hardened washer

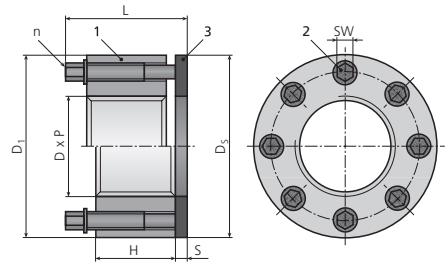

Metric Part number	Size			Nut body		Jackbolt		Hardened washer		Height	Weight	Preload*	Torque*	
	Thread D [mm]	Available pitch P ₁ [mm] P ₂ P ₃			D ₁ [mm]	H [mm]	n	SW [mm]	D _s [mm]	S [mm]	tot L [mm]	est [kg]	nom F [kN]	nom M [Nm]
H650-M20x.../W	M20	2.5	1.5	1	38	16	6	5	38	4	34	0.14	75	10
H650-M22x.../W	M22	2.5	1.5	1	41	16	6	5	41	4	34	0.16	94	12
H650-M24x.../W	M24	3	2	1.5	44	16	8	5	43	4	34	0.19	110	11
H650-M27x.../W	M27	3	2	1.5	50	24	6	6	50	5	45	0.35	140	24
H650-M30x.../W	M30	3.5	2	1.5	53	24	6	6	53	5	45	0.37	175	30
H650-M33x.../W	M33	3.5	2	1.5	59	24	8	6	59	5	45	0.48	215	27
H650-M36x.../W	M36	4	3	1.5	66	32	6	8	66	5	57	0.76	255	53
H650-M39x.../W	M39	4	3	1.5	70	32	8	8	70	5	57	0.90	300	47
H650-M42x.../W	M42	4.5	3	1.5	75	32	8	8	73	5	57	1.01	350	55
H650-M45x.../W	M45	4.5	3	1.5	83	38	8	10	81	6	68	1.48	405	75
H650-M48x.../W	M48	5	3	1.5	85	38	8	10	85	6	68	1.50	455	85
H650-M52x.../W	M52	5	3	2	94	38	8	10	89	6	68	1.80	540	100
H650-M56x.../W	M56	5.5	4	2	100	38	8	10	95	6	68	2.00	630	120
H650-M60x.../W	M60	5.5	4	2	107	38	10	10	100	6	68	2.30	740	110
H650-M64x.../W	M64	6	4	2	113	53	8	14	112	8	92	3.65	830	205
H650-M72x.../W	M72	6	4	2	120	56	8	14	120	8	92	4.00	1070	265
H650-M76x.../W	M76	6	4	2	132	56	12	14	127	8	92	5.10	1200	200
H650-M80x.../W	M80	6	4	2	132	56	12	14	127	8	92	4.80	1330	220
H650-M90x.../W	M90	6	4	2	145	59	16	14	140	8	99	6.00	1730	215
H650-M100x.../W	M100	6	4	2	164	61	16	14	152	8	99	7.80	2170	270
H650-M110x.../W	M110	6	4	2	177	79	12	17	172	10	125	11.40	2650	550
H650-M120x.../W	M120	6	4	2	189	81	16	17	179	10	125	13.00	3210	500
H650-M125x.../W	M125	6	4	2	194	81	16	17	190	10	125	13.50	3470	540

* All preload and torque values are provided for general reference. Applied preload plus additional bolt load from service should not exceed the maximum bolt or stud capacity. Contact your local Nord-Lock sales office for assistance in determining proper preload and torque settings for your application.
- Other sizes, thread pitches or thread per inch (TPI) may be available.
- Dimensions listed are representative.

©Copyright 2018 Nord-Lock Group. NORD-LOCK, SUPERBOLT, BOLTIGHT and EXPANDER SYSTEM are trademarks owned by different companies within the Nord-Lock Group. All other logos, trademarks, registered trademarks or service marks used herein are the property of the Nord-Lock Group. All rights reserved.