

GT

Nut-style tensioner standard- & high-strength

GT Series Tensioners are used for standard- and high-strength bolt loads on many general mechanical applications. Suitable as ISO 898-2 class 8 replacement for use on grades 8.8 or equivalent stud/bolts.

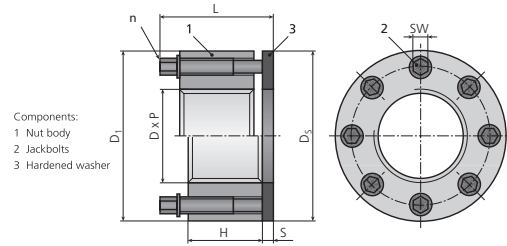

Metric and imperial		Size			Nut body		Jackbolt		Hardened washer		Height	Weight	70% of 8.8 yield strength (reference)*		Preload capacity*	
Part group	Part number	Thread D [mm] or [in.]	Available pitch or TPI			D ₁ [mm]	H [mm]	n	2 SW [mm]	D ₃ [mm]	S [mm]	tot L [mm]	est [kg]	Preload F [kN]	Torque M [Nm]	max [kN]
			P ₁	P ₂	P ₃											
1	GT-M16x.../W	M16	2	1.5	1	37	17	6	5	37	4	34	0.16	70	9	145
	GT-075.../W	3/4	10	16	—											
2	GT-M20x.../W	M20	2.5	1.5	1	40	18	8	5	40	4	34	0.19	110	11	190
	GT-M22x.../W	M22	2.5	1.5	1											
3	GT-M24x.../W	M24	3	2	1.5	50	23	6	6	50	5	45	0.39	160	27	290
	GT-100.../W	1	8	12	14											
4	GT-M27x.../W	M27	3	2	1.5	53	25	7	6	53	5	45	0.36	205	35	290
	GT-112.../W	1-1/8	7	8	12											
5	GT-M30x.../W	M30	3.5	2	1.5	62	28	6	8	62	6	58	0.43	225	32	340
	GT-125.../W	1-1/4	7	8	12											
6	GT-M33x.../W	M33	3.5	2	1.5	65	32	7	8	65	6	58	0.70	310	65	455
	GT-137.../W	1-3/8	6	8	12											
7	GT-M36x.../W	M36	4	3	1.5	71	32	8	8	71	6	58	0.83	335	61	535
	GT-150.../W	1-1/2	6	8	12											
8	GT-M39x.../W	M39	4	3	1.5	75	32	9	8	75	6	58	0.96	435	69	610
	GT-162.../W	1-5/8	6	8	12											
9	GT-M42x.../W	M42	4.5	3	1.5	83	38	7	10	83	8	70	1.06	485	68	685
	GT-175.../W	1-3/4	5	8	12											
10	GT-M45x.../W	M45	4.5	3	1.5	89	38	8	10	89	8	70	1.58	555	119	820
	GT-187.../W	1-7/8	6	8	12											
11	GT-M48x.../W	M48	5	3	1.5	91	38	9	10	91	8	70	1.83	670	126	935
	GT-200.../W	2	4.5	8	12											
12	GT-M52x.../W	M52	5	3	2	102	50	9	12	102	8	85	1.86	785	132	1,050
	GT-M56x.../W	M56	5.5	4	2											
13	GT-M60x.../W	M60	5.5	4	2	111	57	8	14	111	10	101	2.93	910	177	1,400
	GT-225.../W	2-1/4	4.5	8	12											
14	GT-M64x.../W	M64	6	4	2	118	57	9	14	118	10	101	3.99	1,160	290	1,700
	GT-250.../W	2-1/2	4	8	12											
15	GT-M68x.../W	M68	6	4	2	124	62	10	14	124	10	101	3.96	1,200	299	1,700
	GT-275.../W	2-3/4	4	8	12											
16	GT-M72x.../W	M72	6	4	2	133	62	13	14	133	10	101	4.49	1,370	303	1,910
	GT-M76x.../W	M76	6	4	2											
17	GT-300.../W	3	4	6	8	144	72	12	16	144	12	116	5.13	1,550	309	2,120
	GT-M80x.../W	M80	6	4	2											
18	GT-325.../W	3-1/4	4	6	8	151	75	13	16	151	12	116	4.86	1,740	347	2,120
	GT-M85x.../W	M85	6	4	2											
19	GT-350.../W	3-1/2	4	6	8	163	75	15	16	163	12	116	4.85	1,740	346	2,120
	GT-M90x.../W	M90	6	4	2											
20	GT-375.../W	3-3/4	4	6	8	178	102	15	17	178	12	161	5.87	1,950	299	2,760
	GT-M100x.../W	M100	6	4	2											
21	GT-400.../W	4	4	6	8	193	102	18	17	193	12	161	8.45	2,810	483	3,610
	GTX-425.../W	4-1/4	4	6	8											
22	GTX-450.../W	4-1/2	4	6	8	203	114	20	17	203	12	161	10.07	3,130	467	4,160
	GTX-475.../W	4-3/4	4	6	8											
23	GTX-500.../W	5	4	6	8	211	114	22	17	211	12	161	9.90	3,220	480	4,160
	GTX-525.../W	5-1/4	6	4	2											
24	GTX-550.../W	5-1/2	6	4	2	220	127	18	21	220	16	185	24.04	5,440	336	7,710
	GTX-575.../W	5-3/4	4	6	8											
25	GTX-600.../W	6	4	6	8	240	132	20	21	240	16	185	23.35	5,710	352	7,710
	GTX-600.../W	6	4	6	8											
26	GTX-600.../W	6	4	6	8	270	132	23	21	270	16	185	29.10	6,350	578	8,850
	GTX-600.../W	6	4	6	8											
26	GTX-600.../W	6	4	6	8	270	132	23	21	270	16	185	36.87	6,910	565	9,840
	GTX-600.../W	6	4	6	8											
26	GTX-600.../W	6	4	6	8	270	132	23	21	270	16	185	49.68	7,550	537	11,310
	GTX-600.../W	6	4	6	8											

* All preload and torque values are provided for general reference. Applied preload plus additional bolt load from service should not exceed the maximum bolt or stud capacity. Contact your local Nord-Lock sales office for assistance in determining proper preload and torque settings for your application.
- Sizes over M100 or 4" become "GTX" and use Superbolt JL-M lube for reduced torque values.
- Other sizes, thread pitches or thread per inch (TPI) may be available.
- Dimensions listed are representative.